

MC 250/5 Type 321

MC 400/5 Type 323

MC 440/5 Type 324

MAICO

| Picture No. | Part No. | Description | Quantity | | |
|-------------|----------|-------------------------------------|----------|-----|-----|
| | | | 250 | 400 | 440 |
| 1 | 3349 | Crankcase right hand | 1 | 1 | - |
| 2 | 3350 | Guide bush for pawl pin | 1 | 1 | 1 |
| 3 | 331 | Guide bush | 1 | 1 | 1 |
| 4 | 1895 | Pin 8 h 8x14 | 2 | 2 | 2 |
| 5 | 1787 | Stud M 8x28 Din 940 | 4 | 4 | 4 |
| 6 | 3352 | Crankcase left hand | 1 | 1 | - |
| 7 | 1831 | Tension pin 8x10 Din 7346 | 2 | 2 | 2 |
| 8 | 1888 | Pin 5 h x 14 Din 7 | 1 | 1 | 1 |
| 9 | 3353 | Inside ring | 1 | 1 | 1 |
| 10 | 398 | Crankcase cover right hand | 1 | 1 | 1 |
| 11 | 3355 | Crankcase cover left hand | 1 | 1 | 1 |
| 12 | 400 | Oil drain plug complete | 1 | 1 | 1 |
| 13 | 3498 | Crankcase gasket | 1 | 1 | 1 |
| 14 | 3356 | Crankcase cover gasket left | 1 | 1 | 1 |
| 15 | 2969 | Crankcase cover gasket right | 1 | 1 | 1 |
| 16 | 3499 | Ventilation pipe | 1 | 1 | 1 |
| 17 | 1667 | Hexagon nut M 6 Din 934 | 1 | 1 | 1 |
| 18 | 407 | Sealing ring | 7 | 7 | 7 |
| 19 | 408 | Screw plug M 20x1..5 Din 910 | 1 | 1 | 1 |
| 20 | 410 | Sealing ring A 14x18 Din 7603 | 1 | 1 | 1 |
| 21 | 409 | Sealing ring A 20x24 Din 7603 | 1 | 1 | 1 |
| 22 | 1533 | Cylinder head screw A M 6x18 Din 84 | 1 | 1 | 1 |
| 23 | 1546 | Cylinder head screw A M 6x85 Din 84 | 2 | 2 | 2 |
| 24 | 1539 | Cylinder head screw A M 6x40 Din 84 | 7 | 7 | 7 |
| 25 | 1538 | Cylinder head screw A M 6x35 Din 84 | 4 | 4 | 4 |
| 26 | 1537 | Cylinder head screw A M 6x28 Din 84 | 3 | 3 | 3 |
| 27 | 1552 | Cylinder head screw A M 8x16 Din 84 | 1 | 1 | 1 |
| 28 | 430 | Sea;ing ring A 8x14 Din 7603 | 1 | 1 | 1 |
| 29 | 2981 | Crankshaft complete | 1 | - | - |
| 30 | 424 | Needle bearing KBK 18x22x24 | 1 | 1 | 1 |
| 31 | 425 | Ball bearing 6305 Din 625 | 1 | 1 | 1 |
| 31 | 426 | Crankshaft bearing right NU 305 C3 | 1 | 1 | 1 |
| 32 | 693 | Ball bearing 3305 C 3 Din 625 | 1 | 1 | 1 |
| 33 | 547 | Oil seal 32x52x7/9 | 1 | 1 | 1 |
| 34 | 3469 | Oil seal 25x52x8 | 1 | 1 | 1 |
| 35 | 713 | Spacer ring | 1 | 1 | 1 |
| 36 | 3470 | Duplex sprocket | 1 | - | - |
| 37 | 504 | Lock washer | 1 | 1 | 1 |
| 38 | 505 | Sleeve pinion nut | 1 | 1 | 1 |
| 39 | 522 | Piston 66.95 | 1 | - | - |
| 40 | 523 | L-ring | 1 | - | - |
| 41 | 535 | Piston pin | 1 | - | - |
| 42 | 536 | Piston pin clip | 2 | 2 | 2 |
| 43 | 2500 | Cylinder cpl with exhaust manifold | 1 | - | - |
| 44 | 2502 | Cylinder head | 1 | - | - |
| 45 | 65 | Cylinder head gasket | 1 | - | - |
| 46 | 721 | Cylinder base gasket | 1 | - | - |
| 47 | 2967 | Cylinder head stud | 5 | - | - |
| 48 | 1705 | Spring washer B 8 Din 127 | 9 | 9 | 9 |
| 49 | 1670 | Hexagon nut M 8 Din 934 | 4 | 4 | 4 |
| 50 | 78 | Hexagon nut M 8 Din 6330 | 5 | 5 | 5 |
| 51 | 3386 | Clutch guide | 1 | 1 | 1 |
| 52 | 725 | Clutch push pin | 1 | 1 | 1 |

| | | | | | |
|-----|------|---|----|----|----|
| 53 | 1869 | Ball | 14 | 14 | 14 |
| 54 | 455 | Push pin nut | 1 | 1 | 1 |
| 55 | 443 | Duplex primary chain 3/8x7/32 | 1 | - | - |
| 56 | 444 | Thrust washer | 1 | 1 | 1 |
| 57 | 3389 | Bush | 1 | 1 | 1 |
| 58 | 2580 | Clutch body | 1 | 1 | 1 |
| 59 | 447 | Lock washer | 1 | 1 | 1 |
| 60 | 448 | Clutch nut | 1 | 1 | 1 |
| 61 | 449 | Cup spring | 20 | 20 | 20 |
| 62 | 3396 | Outer clutch disc | 6 | 6 | 6 |
| 63 | 3390 | Inner clutch disc | 6 | 6 | 6 |
| 64 | 3391 | Terminal disc | 1 | 1 | 1 |
| 65 | 461 | Lock ring | 2 | 2 | 2 |
| 66 | 462 | Clutch spindle | 1 | 1 | 1 |
| 67 | 464 | Sealing ring | 1 | 1 | 1 |
| 68 | 437 | Clutch lever | 1 | 1 | 1 |
| 69 | 1750 | Washer B 6.4 Din 9021 | 1 | 1 | 1 |
| 70 | 1667 | Hexagon nut M 6 Din 9021 | 1 | 1 | 1 |
| 71 | 3398 | Clutch housing (duplex T=41) | 1 | - | - |
| 72 | 730 | Kickstarter pinion | 1 | 1 | 1 |
| 73 | 731 | Ratchet spring | 1 | 1 | 1 |
| 74 | 732 | Spring cup | 1 | 1 | 1 |
| 75 | 733 | Snap-spring | 1 | 1 | 1 |
| 76 | 729 | Kickstarter ratchet wheel | 1 | 1 | 1 |
| 77 | 1906 | Oval head rivet 4x10 Din 662 | 8 | 8 | 8 |
| 78 | 3433 | Mainshaft "MG" | 1 | 1 | 1 |
| 79 | 3434 | 3rd gear on mainshaft "M" T=24 | 1 | - | - |
| 80 | 3435 | 4th gear on mainshaft "MG" T=26 | 1 | 1 | 1 |
| 81 | 3706 | Spacer ring | 1 | 1 | 1 |
| 82 | 492 | Retainer ring | 3 | 3 | 3 |
| 83 | 3436 | Sleeve pinion "M" T=28 | 1 | - | - |
| 84 | 3454 | Sleeve pinion plug | 1 | 1 | 1 |
| 85 | 3437 | Layshaft "M" T=17 | 1 | - | - |
| 86 | 3456 | Washer 2nd gear | 1 | 1 | 1 |
| 87 | 914 | Washer | 1 | 1 | 1 |
| 88 | 3438 | 1st gear on layshaft "M1" T=26 | 1 | - | - |
| 89 | 905 | Needle bearing K 16x21x10 FV | 1 | 1 | 1 |
| 90 | 3439 | 2nd gear on layshaft "M1" T=23 | 1 | - | - |
| 91 | 3757 | Needle bearing K 20x24x12 | 1 | 1 | 1 |
| 92 | 3461 | Lock ring | 1 | 1 | 1 |
| 93 | 499 | Ball bearing 6005 2RS Din 625 | 1 | 1 | 1 |
| 94 | 1852 | Lock ring 47x1.75 Din 472 | 1 | 1 | 1 |
| 95 | 3462 | Bearing bush | 1 | 1 | 1 |
| 96 | 3463 | Ball bearing 6005 2RS Din 625 | 1 | 1 | 1 |
| 97 | 1854 | Lock ring 55x2 Din 472 | 1 | 1 | 1 |
| 98 | 3464 | Lock ring 55x2 Din 625 | 1 | 1 | 1 |
| 99 | 3465 | Sprocket T=13 | 1 | 1 | 1 |
| 100 | 1848 | Lock ring A 29x1.5 K | 1 | 1 | 1 |
| 101 | 3466 | Needle gauge K 17x21x13 | 3 | 3 | 3 |
| 102 | 749 | Bush | 1 | 1 | 1 |
| 103 | 3440 | 2nd gear on mainshaft "M" T=21 | 1 | - | - |
| 104 | 3441 | 1st gear on mainshaft "M" T=19 | 1 | - | - |
| 105 | 513 | Needle bearing H K 1612 | 1 | 1 | 1 |
| 106 | 514 | Needle bearing B K 1616 | 1 | 1 | 1 |
| 107 | 3442 | Twin block gear on mainshaft "M" T=21/19 | 1 | - | - |
| 108 | 3467 | Washer 1st gear layshaft | 1 | 1 | 1 |
| 109 | 555 | Gear change lever | 1 | 1 | 1 |

| | | | | | |
|-----|------|------------------------------------|---|---|---|
| 110 | 556 | Rubber pad | 1 | 1 | 1 |
| 111 | 1570 | Hexagon screw M 6x25 Din 933 | 1 | 1 | 1 |
| 112 | 1712 | Spring B 6 Din 137 | 1 | 1 | 1 |
| 113 | 2503 | Gear change crank | 1 | 1 | 1 |
| 114 | 3399 | Pull rod | 1 | 1 | 1 |
| 115 | 3402 | Shifting segment | 1 | 1 | 1 |
| 116 | 511 | Plug | 1 | 1 | 1 |
| 117 | 3407 | Shifting plate | 1 | 1 | 1 |
| 118 | 3408 | Gear rack | 1 | 1 | 1 |
| 119 | 1824 | Tension pin | 2 | 2 | 2 |
| 120 | 572 | O-ring | 1 | 1 | 1 |
| 121 | 587 | Lock ring | 1 | 1 | 1 |
| 122 | 3410 | Hooked ratchet | 1 | 1 | 1 |
| 123 | 573 | Return spring | 1 | 1 | 1 |
| 124 | 576 | Hooked ratchet spring | 1 | 1 | 1 |
| 125 | 3411 | Guide rail | 2 | 2 | 2 |
| 126 | 3412 | Flat head screw M 6x16 Din 923 | 2 | 2 | 2 |
| 127 | 3493 | Flat head screw M 6x16 Din 923 | 2 | 2 | 2 |
| 128 | 1712 | Spring washer B 6 Din 137 | 4 | 4 | 4 |
| 129 | 1667 | Hexagon nut M 6 Din 934 | 4 | 4 | 4 |
| 130 | 3413 | Gear selection fork spindle | 1 | 1 | 1 |
| 131 | 3414 | Gear selection fork | 3 | 3 | 3 |
| 132 | 3415 | Pawl pin | 1 | 1 | 1 |
| 133 | 3422 | Compression spring | 1 | 1 | 1 |
| 134 | 410 | Sealing ring A 14x18 Din 7603 | 1 | 1 | 1 |
| 135 | 3416 | Locking screw | 1 | 1 | 1 |
| 136 | 3417 | Tension spring holding screw | 1 | 1 | 1 |
| 137 | 1667 | Nut M 6 Din 934 | 1 | 1 | 1 |
| 138 | 652 | Kickstarter lever (upper) | 1 | 1 | 1 |
| 139 | 2508 | Kickstarter lever (lower) | 1 | 1 | 1 |
| 140 | 1874 | Ball | 1 | 1 | 1 |
| 141 | 655 | Tension spring | 1 | 1 | 1 |
| 142 | 656 | Rubber pad | 1 | 1 | 1 |
| 143 | 1840 | Lock washer 9 Din 6799 | 1 | 1 | 1 |
| 144 | 1816 | Tension pin 3x10 Din 1481 | 1 | 1 | 1 |
| 145 | 3471 | Kickstarter shaft | 1 | 1 | 1 |
| 146 | 659 | O-ring | 2 | 2 | 2 |
| 147 | 1570 | Hexagon screw M 6x25 Din 933 | 1 | 1 | 1 |
| 148 | 1704 | Spring ring B 6 Din 127 | 1 | 1 | 1 |
| 149 | 666 | Kickstarter return spring | 1 | 1 | 1 |
| 150 | 588 | Magneto housing complete | 1 | 1 | 1 |
| 151 | 592 | Rotor bolt | 1 | 1 | 1 |
| 152 | 1714 | Spring washer B 8 Din 137 | 1 | 1 | 1 |
| 153 | 1527 | Cylinder head screw | 1 | 1 | 1 |
| 154 | 1730 | Washer 4.3 Din 125 | 1 | 1 | 1 |
| 155 | 1702 | Spring ring B 4 Din 127 | 1 | 1 | 1 |
| 156 | 611 | Magnet rotor | 1 | 1 | 1 |
| 157 | 1534 | Cylinder head screw AM 6x20 Din 84 | 3 | 3 | 3 |
| 158 | 1732 | Spring ring B 6 Din 127 | 3 | 3 | 3 |
| 159 | 1704 | Washer 6.4 Din 125 | 3 | 3 | 3 |
| 160 | 603 | Spark plug | 2 | 2 | 2 |
| 161 | 609 | Contact breaker | 1 | 1 | 1 |
| 162 | 613 | Carburetor complete | 1 | - | - |
| 163 | 681 | Spacer tube | 1 | 1 | 1 |
| 164 | 3143 | Rubber flange | 1 | 1 | 1 |
| 165 | 683 | Clamp | 3 | 3 | 3 |
| 166 | 343 | Rubber sleeve | 1 | 1 | 1 |
| 167 | 3681 | Crankcase right hand | - | - | 1 |
| 168 | 3682 | Crankcase left hand | - | - | 1 |
| 169 | 709 | Crankshaft complete | - | 1 | 1 |
| 170 | 714 | Triplex sprocket | - | 1 | 1 |

| | | | | | |
|-----|------|--|---|---|---|
| 171 | 735 | Triplex primary chain 3/8x7/32 | - | 1 | 1 |
| 172 | 2577 | Clutch housing (triplex T=39) | - | 1 | 1 |
| 173 | 3443 | 3rd gear on mainshaft "M" T=23 | - | 1 | 1 |
| 174 | 3444 | Sleeve pinion "G" T=29 | - | 1 | 1 |
| 175 | 3445 | Layshaft "G" T=16 | - | 1 | 1 |
| 176 | 3446 | 1st gear on layshaft "G1" T=28 | - | 1 | 1 |
| 177 | 3447 | 2nd gear on layshaft "G1" T=24 | - | 1 | 1 |
| 178 | 3448 | 2nd gear on mainshaft "G" T=20 | - | 1 | 1 |
| 179 | 3449 | 1st gear on mainshaft "G" T=17 | - | 1 | 1 |
| 180 | 3450 | Twin block gear on layshaft "G" T=21/18 | - | 1 | 1 |
| 181 | 533 | Piston 76.95 | - | 1 | - |
| 182 | 534 | L piston ring | - | 1 | - |
| 183 | 2101 | R piston ring | - | 1 | - |
| 184 | 537 | Piston pin | - | 1 | 1 |
| 185 | 715 | Cylinder complete with exhaust manifold | - | 1 | - |
| 186 | 719 | Cylinder head | - | 1 | - |
| 187 | 720 | Cylinder head gasket | - | 1 | - |
| 188 | 2968 | Cylinder head stud | - | 5 | 5 |
| 189 | 2110 | Piston 81.94 | - | - | 1 |
| 190 | 2111 | L piston ring | - | - | 1 |
| 191 | 2591 | Cylinder complete with exhaust manifold | - | - | 1 |
| 192 | 2593 | Cylinder head | - | - | 1 |
| 193 | 2582 | Cylinder head gasket | - | - | 1 |
| 194 | 577 | Cover plate | 1 | 1 | 1 |
| 195 | 579 | Locking plate | 1 | 1 | 1 |
| 196 | 1564 | Hexagon screw M 6x10 Din 933 | 1 | 1 | 1 |
| 197 | 614 | Carburetor complete | - | 1 | 1 |
| 198 | 467 | Exhaust flange | 1 | 1 | 1 |
| 199 | 298 | Exhaust flange gasket | 1 | 1 | 1 |
| 200 | 1635 | Socket screw M 6x25 Din 912 | 1 | 1 | 1 |
| 201 | 1704 | Spring ring B 6 Din 127 | 1 | 1 | 1 |
| 202 | 517 | Decompression valve cpl | - | 1 | 1 |
| 203 | 410 | Sealing ring A 14x18 Din 7603 | - | 1 | 1 |

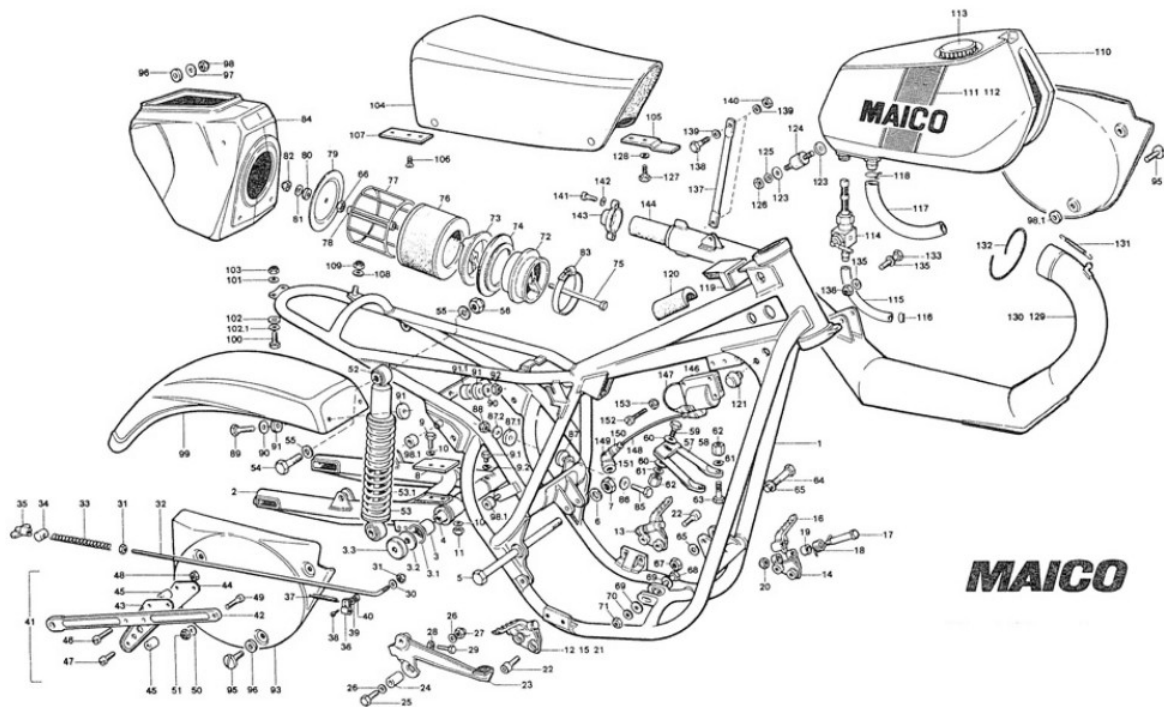

MAICO

MC 250/5 Type 326 MC 400/5 Type 327 MC440/5 Type 328

| Picture No. | Part No. | Description | Quantity | | |
|-------------|----------|------------------------------|----------|-----|-----|
| | | | 250 | 400 | 440 |
| 1 | 3980 | Frame cpl | 1 | 1 | 1 |
| 2 | 3917 | Swing arm cpl | 1 | 1 | 1 |
| 3 | 3932 | Needle bearing HK 2030 | 2 | 2 | 2 |
| 3.1 | 80 | O ring | 2 | 2 | 2 |
| 3.2 | 5008 | Washer | 2 | 2 | 2 |
| 3.3 | 3934 | Dust cover | | | |
| 4 | 3482 | Spacer tube for swing arm | 2 | 2 | 2 |
| 5 | 3937 | Swing arm spindle | 1 | 1 | 1 |
| 6 | 1718 | Washer | 1 | 1 | 1 |
| 7 | 5011 | Lock nut MM 14x15 | 1 | 1 | 1 |
| 8 | 3936 | Swing arm plastic pad | 1 | 1 | 1 |
| 9 | 1567 | Hexagon screw M 6x16 | 2 | 2 | 2 |
| 9.1 | 1554 | Hexagon screw M 6x6 | 1 | 1 | 1 |
| 9.2 | 407 | Sealing ring A x 10 Din 7603 | 1 | 1 | 1 |
| 10 | 1732 | Washer B 6.4 Din 125 | 4 | 4 | 4 |

| | | | | | |
|----|------|---------------------------------------|---|---|---|
| 11 | 1690 | Hexagon nut M 6 Din 985 | 2 | 2 | 2 |
| 12 | 3779 | Foot rest right hand cpl | 1 | 1 | 1 |
| 13 | 3780 | Foot rest left hand cpl | 1 | 1 | 1 |
| 14 | 3564 | Foot rest base plate left hand | 1 | 1 | 1 |
| 15 | 3567 | Foot rest base plate right hand | 1 | 1 | 1 |
| 16 | 3563 | Foot rest | 2 | 2 | 2 |
| 17 | 3569 | Bolt M 8x58x70 | 2 | 2 | 2 |
| 18 | 3568 | Foot rest return spring left hand | 1 | 1 | 1 |
| 19 | 3565 | Bush | 2 | 2 | 2 |
| 20 | 1692 | Self locking nut M 8 Din 980 | 2 | 2 | 2 |
| 21 | 3566 | Foot rest return spring right hand | 1 | 1 | 1 |
| 22 | 1655 | Socket screw M 10x25 | 4 | 4 | 4 |
| 23 | 5090 | Brake pedal | 1 | 1 | 1 |
| 24 | 5093 | Bearing bush | 1 | 1 | 1 |
| 25 | 1500 | Hexagon screw M 6x40 Din 931 | 1 | 1 | 1 |
| 26 | 1732 | Washer B 6.4 Din 125 | 2 | 2 | 2 |
| 27 | 1690 | Lock nut M 6 Din 980 | 1 | 1 | 1 |
| 28 | 1667 | Hexagon nut M 6 din 934 | 1 | 1 | 1 |
| 29 | 1570 | Hexagon screw M 6x25 Din 933 | 1 | 1 | 1 |
| 30 | 1732 | Washer B 6.4 Din 125 | 1 | 1 | 1 |
| 31 | 1690 | Lock nut M 6 Din 980 | 1 | 1 | 1 |
| 32 | 5089 | Brake rod | 1 | 1 | 1 |
| 33 | 242 | Spring | 1 | 1 | 1 |
| 34 | 244 | Nipple | 1 | 1 | 1 |
| 35 | 243 | Wing nut | 1 | 1 | 1 |
| 36 | 237 | Clamp | 1 | 1 | 1 |
| 37 | 236 | Spring | 1 | 1 | 1 |
| 38 | 1527 | Cylinder head screw M 4x10 Din 84 | 1 | 1 | 1 |
| 39 | 1702 | Spring washer B 6 Din 127 | 1 | 1 | 1 |
| 40 | 1665 | Hexagon nut M 6 Din 934 | 1 | 1 | 1 |
| 41 | 3505 | Chain guide cpl | 1 | 1 | 1 |
| 42 | 3506 | Rear brake stopper arm | 1 | 1 | 1 |
| 43 | 3092 | Chain guide plate right hand | 1 | 1 | 1 |
| 44 | 3093 | Chain guide plate left hand | 1 | 1 | 1 |
| 45 | 3094 | Roller | 3 | 3 | 3 |
| 46 | 1539 | Cylinder head screw M 6x40 Din 84 | 2 | 2 | 2 |
| 47 | 1550 | Cylinder head screw M 6x30 Din 84 | 1 | 1 | 1 |
| 48 | 1690 | Hexagon nut M 6 Din 985 | 3 | 3 | 3 |
| 49 | 1652 | Socket screw M 8x20 Din 6912 | 1 | 1 | 1 |
| 50 | 1734 | Washer B 8.4 Din 125 | 1 | 1 | 1 |
| 51 | 1692 | Hexagon nut M 8 Din 985 | 1 | 1 | 1 |
| 52 | 3944 | Shocks cpl (Girling gas shocks) | 2 | 2 | 2 |

| | | | | | |
|------|------|---------------------------------------|---|---|---|
| 53 | 3945 | Spring 7.5 (black) | 2 | 2 | 2 |
| 53.1 | 5075 | Spring 7.75 (red) | 2 | 2 | 2 |
| 54 | 1594 | Hexagn screw M 8x40 Din 931 | 4 | 4 | 4 |
| 55 | 1734 | Washer B 8.4 Din 125 | 8 | 8 | 8 |
| 56 | 1692 | Hexagon nut M 8 Din 985 | 4 | 4 | 4 |
| 57 | 3697 | Support for cylinder | 1 | - | - |
| 58 | 3781 | Support for cylinder | - | 1 | 1 |
| 59 | 1589 | Hexagon screw M 8x20 Din 933 | 1 | 1 | 1 |
| 60 | 1749 | Washer A 8.4 Din 9021 | 2 | 2 | 2 |
| 61 | 1714 | Spring washer B 8 Din 137 | 3 | 3 | 3 |
| 62 | 78 | Hexagon nut N 8 Din 6330 | 3 | 3 | 3 |
| 63 | 1592 | Hexagon screw M 8x30 Din 933 | 2 | 2 | 2 |
| 64 | 1626 | Hexagon screw M 10x1.25x60 Din 960 | 2 | 2 | 2 |
| 65 | 1715 | Spring washer B 10 Din 137 | 4 | 4 | 4 |
| 66 | 1667 | Hexagon nut M 6 Din 934 | 1 | 1 | 1 |
| 67 | 1531 | Lock nut M 10x1.25 Din 98 | 2 | 2 | 2 |
| 68 | 1599 | Hexagon screw M 8x60 Din 931 | 1 | 1 | 1 |
| 69 | 1749 | Washer B 8.4 Din 9021 | 2 | 2 | 2 |
| 70 | 1714 | Spring washer B 8 Din 137 | 1 | 1 | 1 |
| 71 | 78 | Hexagon nut M 8 Din 6330 | 1 | 1 | 1 |
| 72 | 3182 | Flange for outside air box | 1 | 1 | 1 |
| 73 | 3182 | Air box ring | 1 | 1 | 1 |
| 74 | 2485 | Rubber ring for filter box | 1 | 1 | 1 |
| 75 | 3758 | Cylinder screw M 6x130 | 1 | 1 | 1 |
| 76 | 3181 | Foam filter | 1 | 1 | 1 |
| 77 | 3164 | Air filter body | 1 | 1 | 1 |
| 78 | 3885 | Spacer tube | 1 | 1 | 1 |
| 79 | 3805 | Cover for air filter | 1 | 1 | 1 |
| 80 | 2708 | Rubber washer | 1 | 1 | 1 |
| 81 | 1750 | Washer | 1 | 1 | 1 |
| 82 | 1690 | Hexagon nut M 6 Din 985 | 1 | 1 | 1 |
| 83 | 348 | Clamp | 1 | 1 | 1 |
| 84 | 3958 | Air box | 1 | 1 | 1 |
| 85 | 1570 | Hexagon screw M 6x25 Din 933 | 2 | 2 | 2 |
| 86 | 1732 | Washer B 6.4 Din 125 | 2 | 2 | 2 |
| 87 | 3529 | Washer | 2 | 2 | 2 |
| 87.1 | 126 | Rubber washer | 2 | 2 | 2 |
| 87.2 | 1750 | Washer | 2 | 2 | 2 |
| 88 | 1690 | Lock nut M 6 Din 980 | 2 | 2 | 2 |
| 89 | 1572 | Hexagon screw M 6x35 Din 931 | 2 | 2 | 2 |
| 90 | 1750 | Washer | 4 | 4 | 4 |
| 91 | 2708 | Rubber washer | 6 | 6 | 6 |
| 91.1 | 5029 | Spacer bush | 2 | 2 | 2 |
| 92 | 1690 | Nut M 6 Din 980 | 2 | 2 | 2 |
| 93 | 3953 | Number plate right hand | 1 | 1 | 1 |

| | | | | | |
|-------|------|------------------------------------|-----|---|---|
| 94 | 3955 | Number plate left hand | 1 | 1 | 1 |
| 95 | 3711 | Flat head screw M 6x22 | 6 | 6 | 6 |
| 96 | 2708 | Rubber washer | 8 | 8 | 8 |
| 97 | 1744 | Washer | 2 | 2 | 2 |
| 98 | 1690 | Hexagon nut M 6x18 Din 933 | 2 | 2 | 2 |
| 98.1 | 5029 | Spacer bush | 4 | 4 | 4 |
| 99 | 141 | Rear fender | 4 | 4 | 4 |
| 100 | 1568 | Hexagon screw M 6x18 Din933 | 1 | 1 | 1 |
| 101 | 1732 | Washer B 6.4 Din 125 | 2 | 2 | 2 |
| 102 | 2708 | Rubber washer | 2 | 2 | 2 |
| 102.1 | 1750 | Washer | 2 | 2 | 2 |
| 103 | 1690 | Hexagon nut M 6 Din 980 | 2 | 2 | 2 |
| 104 | 3285 | Seat cpl (with clamps) | 1 | 1 | 1 |
| 105 | 286 | Clamp holder for seat | 1 | 1 | 1 |
| 106 | 1812 | Oval head screw M 6x16 | 2 | 2 | 2 |
| 107 | 287 | Seat holding plate | 1 | 1 | 1 |
| 108 | 1734 | Washer B 8.4 Din 125 | 1 | 1 | 1 |
| 109 | 1692 | Hexagon nut M 8 Din 980 | 1 | 1 | 1 |
| 110 | 3519 | Tank | 1 | 1 | 1 |
| 111 | 3520 | Maico emblem left hand | 1 | 1 | 1 |
| 112 | 3521 | Maico emblem right hand | 1 | 1 | 1 |
| 113 | 3429 | Tank cap | 1 | 1 | 1 |
| 114 | 2831 | Gasoline tap | 1 | 1 | 1 |
| 115 | 3523 | Gasoline hose | 1 | 1 | 1 |
| 116 | 2832 | Hose clip | 2 | 2 | 2 |
| 117 | 5324 | Gasoline hose | 1 | 1 | 1 |
| 118 | 3525 | Hose clip | 2 | 2 | 2 |
| 119 | 3526 | Tank mounting rubber | 1 | 1 | 1 |
| 120 | 3527 | Rubber pad for tank | 2 | 2 | 2 |
| 121 | 3866 | Moulded rubber mount | 2 | 2 | 2 |
| 122 | | | | | |
| 123 | 3529 | Washer | 4 | 4 | 4 |
| 124 | 1062 | Moulded rubber mount | 2 | 2 | 2 |
| 125 | 1732 | Washer B 6.4 Din 125 | 2 | 2 | 2 |
| 126 | 1690 | Hexagon nut M 6 Din 985 | 4 | 4 | 4 |
| 127 | 1567 | Hexagon screw | 2 | 2 | 2 |
| 128 | 1704 | Spring washer B 6 Din 127 | 2 | 2 | 2 |
| 129 | 3612 | Exhaust system cpl (end pipe 32mm) | (1) | - | - |
| 130 | 3517 | Exhaust system cpl | - | 1 | 1 |
| 131 | 189 | Tension spring | 1 | 1 | 1 |
| 132 | 896 | Asbestos cord | 1 | 1 | 1 |
| 133 | 1595 | Hexagon screw M 8x45 Din 931 | 1 | 1 | 1 |
| 134 | 5110 | Exhaust system cpl (end pipe 25mm) | 1 | - | - |
| 135 | 1749 | Washer A 8.4 Din 9021 | 2 | 2 | 2 |
| 136 | 1692 | Hexagon nut M 8 Din 980 | 1 | 1 | 1 |
| 137 | 3611 | Exhaust brace | 1 | 1 | 1 |

| | | | | | |
|-----|------|--------------------------------------|---|---|---|
| 138 | 1567 | Hexagon screw | 2 | 2 | 2 |
| 139 | 1732 | Washer B 6.4 | 4 | 4 | 4 |
| 140 | 1690 | Hexagon nut M 6 Din 980 | 2 | 2 | 2 |
| 141 | 1550 | Cylinder head screw M 6x30 Din 84 | 2 | 2 | 2 |
| 142 | 1704 | Spring washer B 6 Din 127 | 2 | 2 | 2 |
| 143 | 3516 | End piece | 1 | 1 | 1 |
| 144 | 3557 | Exhaust packing | 1 | 1 | 1 |
| 145 | | | | | |
| 146 | 1124 | Ignition coil | 1 | 1 | 1 |
| 147 | 605 | Ground cable | 1 | 1 | 1 |
| 148 | 589 | High tension lead | 1 | 1 | 1 |
| 149 | 599 | Cable plug | 1 | 1 | 1 |
| 150 | 600 | Rubber sleeve | 2 | 2 | 2 |
| 151 | 601 | Rubber sleeve | 1 | 1 | 1 |
| 152 | 1530 | Cylinder head screw M 5x25 Din 84 | 2 | 2 | 2 |
| 153 | 1689 | Hexagon nut M 5 Din 985 | 2 | 2 | 2 |

MC 250/5 Type 326 MC 400/5 Type 327 MC 440/5 Type 328

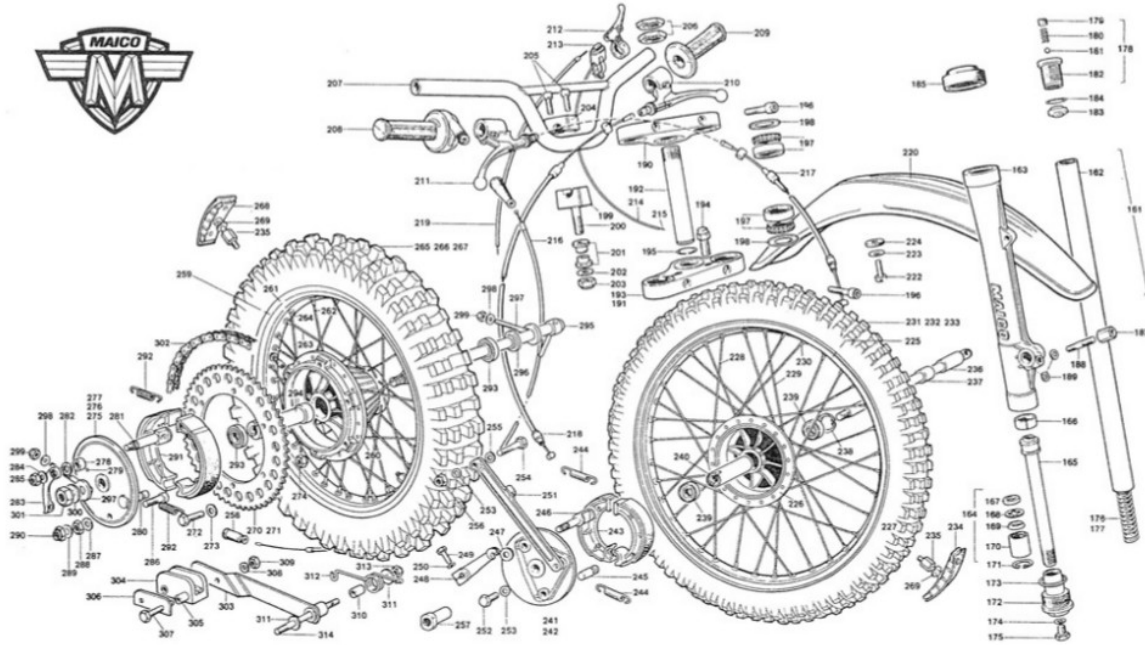

| Picture No. | Part No. | Description | Quantity | | |
|-------------|----------|-------------------------------------|----------|-----|-----|
| | | | 250 | 400 | 440 |
| 161 | 3914 | Telescopic fork cpl | 1 | 1 | 1 |
| 162 | 3790 | Fork tube | 2 | 2 | 2 |
| 163 | 3906 | Fork slider | 2 | 2 | 2 |
| 164 | 3912 | Damper cpl | 2 | 2 | 2 |
| 165 | 3908 | Damper tube | 2 | 2 | 2 |
| 166 | 3789 | Damper piston ring | 2 | 2 | 2 |
| 167 | 3913 | Damper return buffer washer | 2 | 2 | 2 |
| 168 | 3369 | Valve seat | 2 | 2 | 2 |
| 169 | 3368 | Valve | 2 | 2 | 2 |
| 170 | 3367 | Damper insert | 2 | 2 | 2 |
| 171 | 3366 | Locking ring 34 c 1.5 Din 472 | 2 | 2 | 2 |
| 172 | 3365 | Damper cone | 2 | 2 | 2 |
| 173 | 80 | O ring 29 x 2.5 | 2 | 2 | 2 |
| 174 | 430 | Sealing ring A 8x14 Din 7603 | 2 | 2 | 2 |
| 175 | 1585 | Hexagon screw M 8x10 Din | 2 | 2 | 2 |
| 176 | 3915 | Fork spring 4.75 hard (Marked red) | 2 | 2 | 2 |
| 177 | 3915 | Fork spring 4.6 soft (marked white) | 2 | 2 | 2 |

| | | | | | |
|-----|------|---|----|----|----|
| 178 | 3376 | Breather screw cpl | 2 | 2 | 2 |
| 179 | 1785 | Stud | 2 | 2 | 2 |
| 180 | 75 | Valve spring | 2 | 2 | 2 |
| 181 | 1873 | Ball 6 | 2 | 2 | 2 |
| 182 | 3377 | Breather screw | 2 | 2 | 2 |
| 183 | 3378 | Breather screw plug | 2 | 2 | 2 |
| 184 | 80 | O ring 29 x 2.5 | 2 | 2 | 2 |
| 185 | 3907 | Wiper | 2 | 2 | 2 |
| 186 | | | | | |
| 187 | 78 | Hexagon nut M 8 Din 6330 | 2 | 2 | 2 |
| 188 | 1772 | Stud M 8x25 Din 835 | 2 | 2 | 2 |
| 189 | 1734 | Washer B 8.4 Din 125 | 2 | 2 | 2 |
| 190 | 3381 | Upper cross head | 1 | 1 | 1 |
| 191 | 3371 | Lower cross head cpl (with steering tube) | 1 | 1 | 1 |
| 192 | 3373 | Steering tube | 1 | 1 | 1 |
| 193 | 3372 | Lower cross head | 1 | 1 | 1 |
| 194 | 226 | Locking bolt | 2 | 2 | 2 |
| 195 | 3375 | Spring ring A 26 Din 7993 | 1 | 1 | 1 |
| 196 | 1657 | Socket screw M 10x40 Din 912 | 4 | 4 | 4 |
| 197 | 3297 | Roller bearing | 2 | 2 | 2 |
| 198 | 3296 | Nilos ring | 2 | 2 | 2 |
| 199 | 90 | Handlebar clamp lower | 2 | 2 | 2 |
| 200 | 1661 | Socket screw M 10x60 Din 6912 | 2 | 2 | 2 |
| 201 | 15 | Rubber buffer | 4 | 4 | 4 |
| 202 | 1758 | Washer | 2 | 2 | 2 |
| 203 | 1693 | Hexagon nut M 8x30 Din 912 | 2 | 2 | 2 |
| 204 | 88 | Handlebar clamp upper | 2 | 2 | 2 |
| 205 | 1646 | Socket screw M 8x30 Din 912 | 2 | 2 | 2 |
| 206 | 3533 | Hexagon nut | 2 | 2 | 2 |
| 207 | 3784 | Handlebar | 1 | 1 | 1 |
| 208 | 2511 | Twist grip | 1 | 1 | 1 |
| 209 | 2512 | Rubber grip | 1 | 1 | 1 |
| 210 | 145 | Clutch lever | 1 | 1 | 1 |
| 211 | 146 | Brake lever | 1 | 1 | 1 |
| 212 | 148 | Decompression lever | - | 1 | 1 |
| 213 | 571 | Kill button | 1 | 1 | 1 |
| 214 | 2608 | Isolation hose | 1 | 1 | 1 |
| 215 | 2618 | Cable | 1 | 1 | 1 |
| 216 | 2456 | Throttle cable | 1 | 1 | 1 |
| 217 | 486 | Brake cable | 1 | 1 | 1 |
| 218 | 311 | Clutch cable | 1 | 1 | 1 |
| 219 | 305 | Cable for decompressor | - | 1 | 1 |
| 220 | 131 | Front fender | 1 | 1 | 1 |
| 221 | | | | | |
| 222 | 1536 | Cylinder head screw M 6x26 Din 84 | 4 | 4 | 4 |
| 223 | 1750 | Washer A 6.4 Din 9021 | 4 | 4 | 4 |
| 224 | 2708 | Rubber washer | 4 | 4 | 4 |
| 225 | 2426 | Front wheel cpl (with tire) | 1 | 1 | 1 |
| 226 | 2420 | Conical front drum | 1 | 1 | 1 |
| 227 | 3497 | Alum. Front rim 1.60x21" | 1 | 1 | 1 |
| 228 | 2432 | Front spokes short | 18 | 18 | 18 |
| 229 | 2433 | Front spokes long | 18 | 18 | 18 |
| 230 | 210 | Spoke nipple M 4 | 36 | 36 | 36 |
| 231 | 2003 | Tire 3.00x21" | 1 | 1 | 1 |
| 232 | 2002 | Air tube 3.00x21" | 1 | 1 | 1 |
| 233 | 167 | Rim strap | 1 | 1 | |
| 234 | 168 | Tire holder front cpl | 1 | 1 | 1 |
| 235 | 289 | Nut for tire holder | 2 | 2 | 2 |
| 236 | 169 | Front axle | 1 | 1 | 1 |

| | | | | | |
|-----|------|-------------------------------|----|----|----|
| 237 | 2429 | Distance bush | 1 | 1 | 1 |
| 238 | 1853 | Lock ring 35x1.5 Din 472 | 1 | 1 | 1 |
| 239 | 2427 | Ball bearing 6202 RS din 625 | 2 | 2 | 2 |
| 240 | 2428 | Spacer tube | 1 | 1 | 1 |
| 241 | 2416 | Front brake plate cpl | 1 | 1 | 1 |
| 242 | 2417 | Front brake plate | 1 | 1 | 1 |
| 243 | 1322 | Brake shoe | 2 | 2 | 2 |
| 244 | 1323 | Tension spring | 2 | 2 | 2 |
| 245 | 2418 | Pivot bolt | 1 | 1 | 1 |
| 246 | 2419 | Brake toggle | 1 | 1 | 1 |
| 247 | 187 | Rubber washer | 1 | 1 | 1 |
| 248 | 1324 | Front brake lever | 1 | 1 | 1 |
| 249 | 1569 | Hexagon screw M 6x20 Din 933 | 1 | 1 | 1 |
| 250 | 1704 | Spring washer B 6 Din 1271 | 1 | 1 | 1 |
| 251 | 2424 | Front brake rod | 1 | 1 | 1 |
| 252 | 1589 | Hexagon screw M 8x20 Din 933 | 1 | 1 | 1 |
| 253 | 1714 | Spring washer B 8 Din 125 | 2 | 2 | 2 |
| 254 | 1594 | Hexagon screw M 8x40 Din 931 | 1 | 1 | 1 |
| 255 | 1734 | Washer B 8.4 Din 125 | 1 | 1 | 1 |
| 256 | 1692 | Hexagon nut M 8 Din 985 | 1 | 1 | 1 |
| 257 | 2430 | Threaded bush | 1 | 1 | 1 |
| 258 | 1127 | Hermetical cover | 1 | 1 | 1 |
| 259 | 3785 | Rear wheel cpl (with tire) | 1 | 1 | 1 |
| 260 | 3278 | Rear brake drum | 1 | 1 | 1 |
| 261 | 3228 | Alum. Akront rim 2.15x18" | 1 | 1 | 1 |
| 262 | 3198 | Rear spokes short | 18 | 18 | 18 |
| 263 | 3199 | Rear spokes long | 18 | 18 | 18 |
| 264 | 210 | Spoke nipple | 36 | 36 | 36 |
| 265 | 2008 | Tire 4.50x18" | 1 | 1 | 1 |
| 266 | 2015 | Air tube 4.50x18" | 1 | 1 | 1 |
| 267 | 2005 | Rim strap | 1 | 1 | 1 |
| 268 | 2434 | Tire holder rear | 1 | 1 | 1 |
| 269 | 1734 | Washer B 8.4 Din 125 | 2 | 2 | 2 |
| 270 | 3227 | Sprocket 56T | 1 | 1 | 1 |
| 271 | 288 | Sprocket 52T | 1 | 1 | 1 |
| 272 | 3280 | Hexagon screw M 7x40 Din 933 | 6 | 6 | 6 |
| 273 | 1713 | Spring washer B 7 Din 137 | 6 | 6 | 6 |
| 274 | 1691 | Hexagon nut M 7 Din 985 | 6 | 6 | 6 |
| 275 | 3186 | Rear brake plate cpl | 1 | 1 | 1 |
| 276 | 3187 | Rear brake plate | 1 | 1 | 1 |
| 277 | 3188 | Cover plate | 1 | 1 | 1 |
| 278 | 183 | Distance bush | 1 | 1 | 1 |
| 279 | 1901 | Oval head nail 3x8 Din 1476 | 1 | 1 | 1 |
| 280 | 3189 | Pivot bolt | 1 | 1 | 1 |
| 281 | 151 | Brake toggle | 1 | 1 | 1 |
| 282 | 187 | Rubber washer | 1 | 1 | 1 |
| 283 | 3190 | Brake lever | 1 | 1 | 1 |
| 284 | 1734 | Washer B 8.4 Din 125 | 1 | 1 | 1 |
| 285 | 1692 | Hexagon nut M 8 Din 985 | 1 | 1 | 1 |
| 286 | 3270 | Socket screw M 10x40 Din 6912 | 1 | 1 | 1 |
| 287 | 1715 | Washer B 10.5 Din 137 | 1 | 1 | 1 |
| 288 | 1674 | Hexagon nut M 10 Din 934 | 1 | 1 | 1 |
| 289 | 1735 | Washer B 10.5 Din 125 | 1 | 1 | 1 |

| | | | | | |
|-----|------|---|---|---|---|
| 290 | 1693 | Hexagon nut M 10 Din 985 | 1 | 1 | 1 |
| 291 | 188 | Brake shoe | 2 | 2 | 2 |
| 292 | 189 | Tension spring | 2 | 2 | 2 |
| 293 | 205 | Ball bearing 6303 2 RS C3 | 2 | 2 | 2 |
| 294 | 3276 | Spacer tube | 1 | 1 | 1 |
| 295 | 3277 | Rear axle | 1 | 1 | 1 |
| 296 | 3196 | Spacer bush | 1 | 1 | 1 |
| 297 | 223 | Chain adjuster | 2 | 2 | 2 |
| 298 | 1734 | Washer B 8.4 Din 125 | 2 | 2 | 2 |
| 299 | 1692 | Hexagon nut M 8 Din 985 | 2 | 2 | 2 |
| 300 | 1739 | Washer B17 Din 125 | 1 | 1 | 1 |
| 301 | 1683 | Hexagon nut | 1 | 1 | 1 |
| 302 | 3708 | Chain with master link 5/8x1/4" 118 links | 1 | 1 | 1 |
| 303 | 5010 | Chain tension bar | 1 | 1 | 1 |
| 304 | 5015 | Guide rail for chain | 1 | 1 | 1 |
| 305 | 5016 | Spacer bush | 2 | 2 | 2 |
| 306 | 5017 | Plate | 1 | 1 | 1 |
| 307 | 1580 | Hexagon screw M 6x45 Din 933 | 2 | 2 | 2 |
| 308 | 1732 | Washer B 6.4 Din 125 | 2 | 2 | 2 |
| 309 | 1690 | Lock nut M 6 Din 980 | 2 | 2 | 2 |
| 310 | 5019 | Bush | 1 | 1 | 1 |
| 311 | 1749 | Washer A 8.4 Din 9021 | 2 | 2 | 2 |
| 312 | 5020 | Stem spring | 1 | 1 | 1 |
| 313 | 1692 | Lock nut M 8 Din 980 | 1 | 1 | 1 |